

GUTTER STYLES & PROFILES offered by NSHS

Colonial

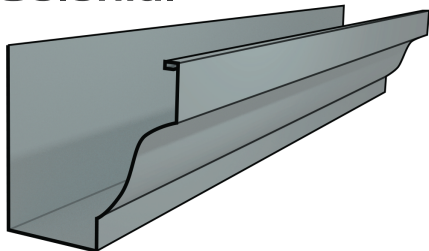

The **Colonial** gutter is the most common for residential applications in Vancouver and the Lower Mainland. A relatively wide bottom allows for a large outlet to be installed and attached to the downpipe. Debris is less likely to be trapped as much as gutter profiles with narrow bottoms.

NSHS offer 4", 5" and 6" Colonial style gutters.

Fascia Style

Fascia Style gutters give the appearance of a fascia board, and consequently they have been termed "Fascia". Fascia style gutters are generally used where the builder has not installed a fascia board over the sub-fascia. The greater depth allows the gutter to cover the 2 x 4" sub-fascia and soffit J-Trim for a clean look. They can also be used on a larger fascia board (2 x 6" or 2 x 8", etc.) if the style is preferred.

NSHS provides fascia styles in **Crown Mould**, **Two Step**, **Triple Cove**, and **Super Five** profiles.

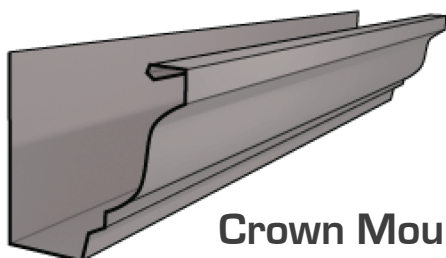

Crown Mould

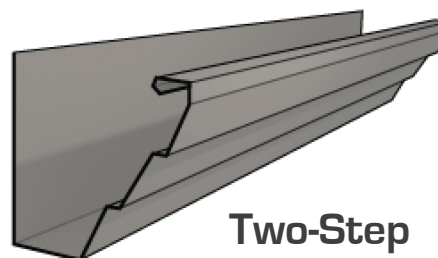

Two-Step

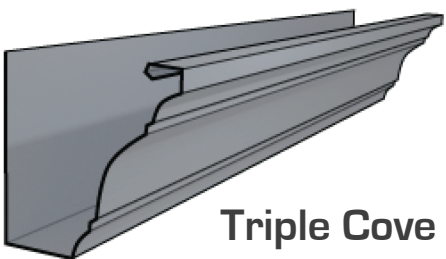

Triple Cove

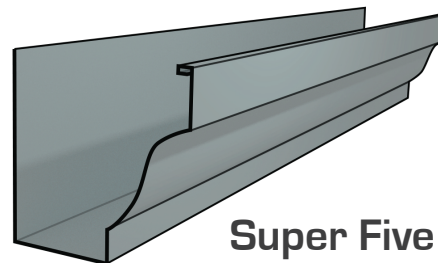

Super Five

Euro Half-Round

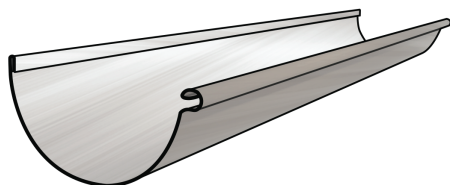

The **Euro Half Round** gutter is very popular for its elegance. The unique round base of the Euro Half-Round gutter prevents buildup from water and dirt and allows the gutter to virtually clean itself with each rainfall. This style gutter is frequently installed on high-end custom homes, where a rich look and character is required.

The Euro Half-Round gutter is available in both 5" and 6" sizes, and in a choice of material including **aluminum**, **copper**, or **zinc**.